

NOTICE OF INTENT TO HARVEST TIMBER

A Timber Harvesting Plan (Plan) or Amendment has been submitted to the California Department of Forestry & Fire Protection (CAL FIRE). CAL FIRE will be reviewing the proposed timber operation for compliance with State law and rules of the Board of Forestry and Fire Protection. The following briefly describes the proposed timber operation and where and how to get more information. In accordance with the timeline stated under Public Resources Code Section 4582.7, you may submit written public comments on the Plan or Amendment for CAL FIRE to consider.

This notice applies to (select one):

- ☒ New Timber Harvesting Plan
☐ Amendment Approved Timber Harvesting Plan

Applicant Information (Timberland Owner(s), Registered Professional Forester who prepared the plan and Plan Submitter should match those listed in the plan or amendment.)

1. The name(s) of the Timberland Owner(s) where timber operations are to occur: Sierra Pacific Land & Timber
2. Registered Professional Forester who prepared the plan or amendment: Andrew Bray
Registered Professional Forester Phone (optional): _____
3. The name of the Plan or Amendment Submitter: Sierra Pacific Industries

Project Summary (County, legal description, acres proposed to be harvested and treatments to be used should match those listed in the plan or amendment.)

4. Location of the proposed timber operation (county, legal description, approximate direction & approximate distance of the timber operation from the nearest community or well-known landmark):
Tehama County; T29N R02E Sections 22, 26, 27, 28, 31, 32, 33, 34, 35; T29N R03E Sections 29, 30, 31, 32;
T28N R02E Sections 4, 5, 6; T28N R01E Section 1 Mount Diablo BM; Approximately 5 miles west of Mineral, CA
5. The name of, and distance from, the nearest perennial stream and major watercourse flowing through or downstream from the timber operation:
The headwaters of Paynes Creek, Chapman Gulch, Plum Creek and Carter Creek flow through the plan area.

6. Acres proposed to be harvested: 1616
7. The regeneration methods and intermediate treatments to be used:
Commercial thinning, shaded fuelbreak, alternative (closest to clearcut), and road right-of-way.
POWERLINES: 14 CCR 1032.7(d)(10) & (e) (provide name and mailing addresses of the utilities for department distribution)
Pacific Gas & Electric Co., ATTN: John Breazeal, 4636 Missouri Flat Rd, Placerville, CA 95667
8. Overhead electrical power lines within the plan boundary? (except lines from transformers to service panels) ☒ Yes
☐ No
9 Overhead powerlines within 200 feet outside the plan boundary? ☒ Yes ☐ No

DEC 20 2023

Public Information: The review times allowed for CAL FIRE to review the proposed timber operation are variable in length, but limited. To ensure CAL FIRE receives your comments please read the following:

The estimated earliest possible date CAL FIRE may **APPROVE** the Plan or Amendment is:
12/30/2023

(This date is 15 calendar days from receipt of the Plan or Amendment by CAL FIRE, except in counties for which special rules have been adopted where the earliest date is 45 calendar days after receipt.)

NOTE: THE ESTIMATED EARLIEST APPROVAL DATE IS PROBABLY NOT THE ACTUAL APPROVAL DATE. Normally, a much longer period of time is available for public comment and preparation of CAL FIRE's responses to public comments. Please check with CAL FIRE, prior to the above listed date, to determine the actual date that the public comment period closes.

The public may review, or purchase a copy of, the Plan or Amendment at the CAL FIRE Review Team Office shown below. The cost to obtain a copy is 37 cents for each page, \$2.50 minimum per request. The cost to obtain a copy of this plan or amendment is: \$96.57

(to be completed by CAL FIRE upon receipt of plan).

Questions or concerns regarding this plan should be directed to the CAL FIRE Review Team Office shown below or emailed to ReddingPublicComment@fire.ca.gov for incorporation into an Official Response Document. Please include the plan number on all correspondence.

Forest Practice Program Manager

CAL FIRE

6105 Airport Road

Redding, CA 96002

(530) 224-2445

The plan may be viewed online at <https://caltreesplans.resources.ca.gov/caltrees/> A map showing the approximate boundary of the THP area, a map legend, and a scale is attached to help in locating where the proposed timber operation is to occur.

For CAL FIRE Use Only

Timber Harvest Plan Number: _____ Date of Receipt: _____

2-23-00169 TEH

Resub

RECEIVED

By Redding Forest Practice at 7:27 am, Dec 15, 2023

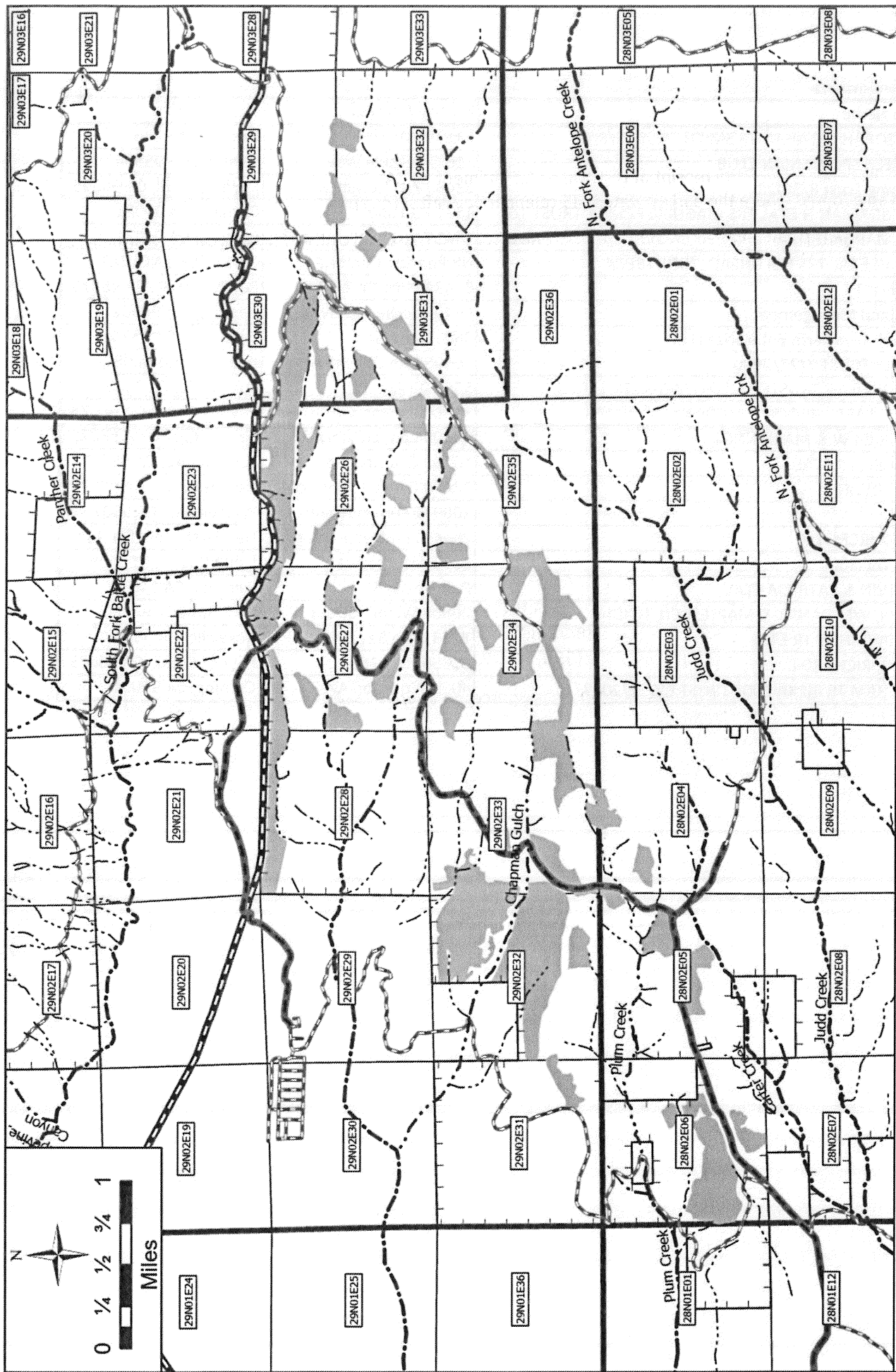

Finley Timber Harvest Plan

Plan Overview

Adjacent Landowners

Landowner Name	Mailing Address	City/State/Zip
SMITH, DEBORAH CALAHAN TR SMITH TRUST 5/8/08	6 NORMANDY LN	Orinda, CA 94563
PAYNES CREEK SPORTSMAN CLUB	316 Creekside Way	Winters, CA 95694
Portales Living Trust 8/30/21	33480 Plum Creek Rd	Paynes Creek, CA 96075
MAGUIRE, NORMAN H ETAL TRS MAGUIRE FAMILY TRUST 10	1541 Fig Lane	Corning, CA 96021
MAGUIRE, MARGARETH A	1541 Fig Lane	Corning, CA 96021
DAVIS, BRIAN ETAL TRS FIELDHEAD, TROUTBECK	NR Penrith, Cumbria	CA 11 OSH ENGL ND
Jones, Norma H	33484 Plum Creek Rd	Paynes Creek, CA 96075
Bureau of Land Management	6640 Lockheed Drive	Redding, CA 96002
Paynes Creek Tree Farm Enterprise LLC	3608 Agneta Ct	Elk Grove, CA 95758
NULL FAMILY TRUST 7/27/2000	20405 Live Oak Rd	Red Bluff, CA 96080
MOEZIDIS, SHEILA Z TRUSTEE S Z MOEZIDIS REV L/TR 3	559 Gail Ave	Sunnyvale, CA 94086
MCDONALD, LARRY BROOK & MCDONALD, LINDA L	33880 Canyon View Loop	Paynes Creek, CA 96075
ALLEN, PATRICK W & MARIANNE L	34000 Canyon View Loop	Paynes Creek, CA 96075
Sisneros, Melvin P ETAL	10160 Countryside Way	Sacramento, CA 95827
SISNEROS, EDWIN J	34470 Canyon View Loop	Paynes Creek, CA 96075
AMES, JON	2089 Green Valley Rd	Watsonville, CA 95076
REEVE RESOURCES, LLC	2844 Saint Dizier Drive	Henderson, NV 89044
Anderson, William	912 Prospect Ave	Santa Rosa, CA 95409
FONG, MELVIN & PATRICIA ETAL	P.O. Box 374	Fairfield, CA 94533
MAPLES DEN, WM DANIEL & MAPLES DEN, HEIDI L	20509 Walnut Street	Red Bluff, CA 96080
MULLINS, DWIGHT E TR ETAL	7263 Lyne Bay Drive	Roseville, CA 95747
MONTARBO, RICHARD L	35350 Hwy 36E	Paynes Creek, CA 96075
RIPKA, WILLIAM TR RIPKA 2003 TRUST 02/12/2003	4015 Woodson Ave	Corning, CA 96021